

LAWN

NORTH

Landscape Design by:

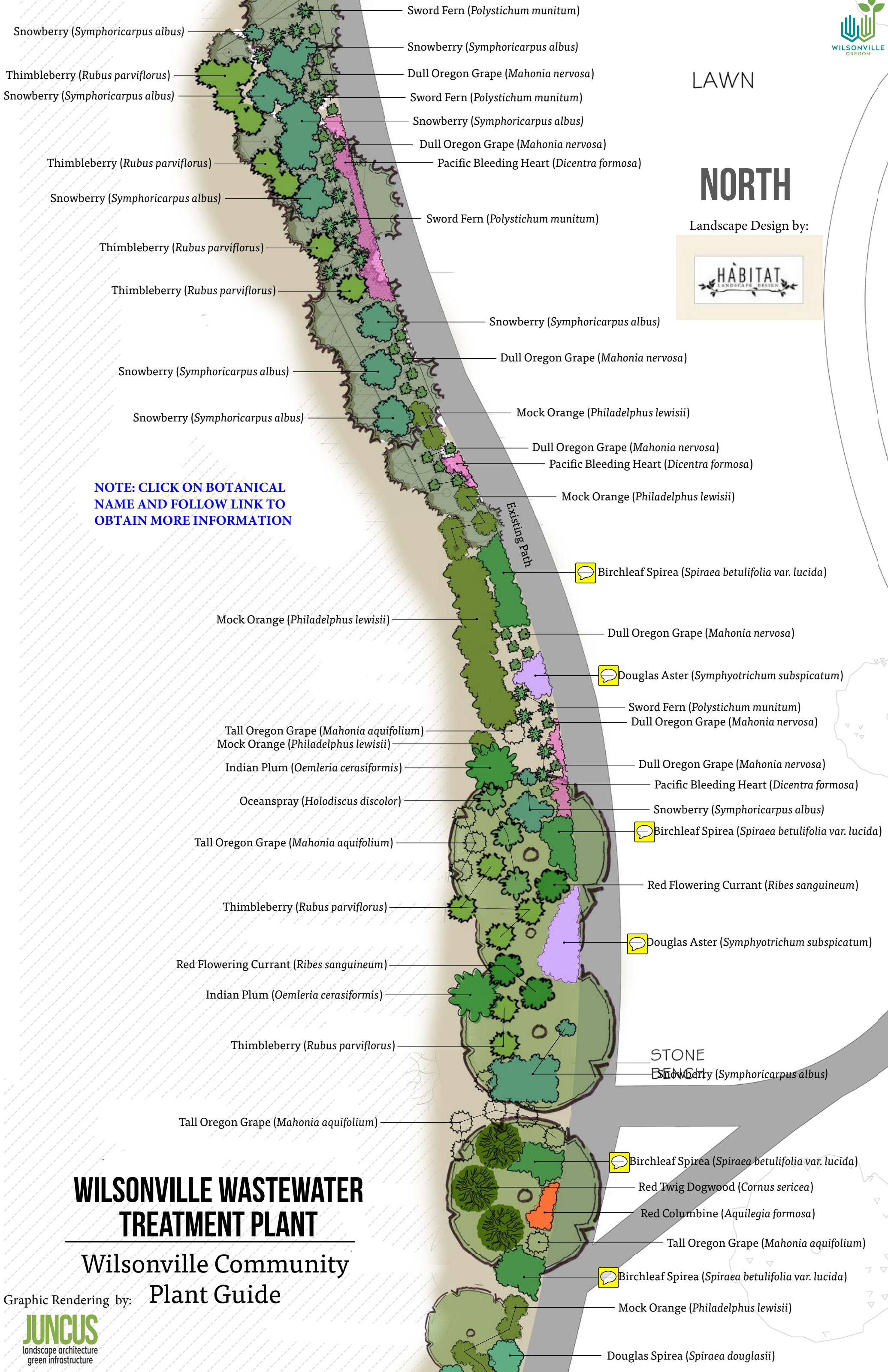

- Snowberry (*Symphoricarpus albus*)
- Thimbleberry (*Rubus parviflorus*)
- Snowberry (*Symphoricarpus albus*)
- Thimbleberry (*Rubus parviflorus*)
- Snowberry (*Symphoricarpus albus*)
- Thimbleberry (*Rubus parviflorus*)
- Thimbleberry (*Rubus parviflorus*)
- Snowberry (*Symphoricarpus albus*)
- Snowberry (*Symphoricarpus albus*)

- Sword Fern (*Polystichum munitum*)
- Snowberry (*Symphoricarpus albus*)
- Dull Oregon Grape (*Mahonia nervosa*)
- Sword Fern (*Polystichum munitum*)
- Snowberry (*Symphoricarpus albus*)
- Dull Oregon Grape (*Mahonia nervosa*)
- Pacific Bleeding Heart (*Dicentra formosa*)
- Sword Fern (*Polystichum munitum*)
- Snowberry (*Symphoricarpus albus*)
- Dull Oregon Grape (*Mahonia nervosa*)
- Mock Orange (*Philadelphus lewisii*)
- Dull Oregon Grape (*Mahonia nervosa*)
- Pacific Bleeding Heart (*Dicentra formosa*)
- Mock Orange (*Philadelphus lewisii*)

NOTE: CLICK ON BOTANICAL NAME AND FOLLOW LINK TO OBTAIN MORE INFORMATION

Mock Orange (*Philadelphus lewisii*)

Tall Oregon Grape (*Mahonia aquifolium*)
Mock Orange (*Philadelphus lewisii*)

Indian Plum (*Oemleria cerasiformis*)

Oceanspray (*Holodiscus discolor*)

Tall Oregon Grape (*Mahonia aquifolium*)

Thimbleberry (*Rubus parviflorus*)

Red Flowering Currant (*Ribes sanguineum*)

Indian Plum (*Oemleria cerasiformis*)

Thimbleberry (*Rubus parviflorus*)

Tall Oregon Grape (*Mahonia aquifolium*)

Birchleaf Spirea (*Spiraea betulifolia var. lucida*)

Dull Oregon Grape (*Mahonia nervosa*)

Douglas Aster (*Symphyotrichum subspicatum*)

Sword Fern (*Polystichum munitum*)
Dull Oregon Grape (*Mahonia nervosa*)

Dull Oregon Grape (*Mahonia nervosa*)

Pacific Bleeding Heart (*Dicentra formosa*)

Snowberry (*Symphoricarpus albus*)

Birchleaf Spirea (*Spiraea betulifolia var. lucida*)

Red Flowering Currant (*Ribes sanguineum*)

Douglas Aster (*Symphyotrichum subspicatum*)

STONE BENCH
Snowberry (*Symphoricarpus albus*)

Birchleaf Spirea (*Spiraea betulifolia var. lucida*)

Red Twig Dogwood (*Cornus sericea*)

Red Columbine (*Aquilegia formosa*)

Tall Oregon Grape (*Mahonia aquifolium*)

Birchleaf Spirea (*Spiraea betulifolia var. lucida*)

Mock Orange (*Philadelphus lewisii*)

Douglas Spirea (*Spiraea douglasii*)

WILSONVILLE WASTEWATER TREATMENT PLANT

Wilsonville Community Plant Guide

Graphic Rendering by: