

# SITE CONTEXT

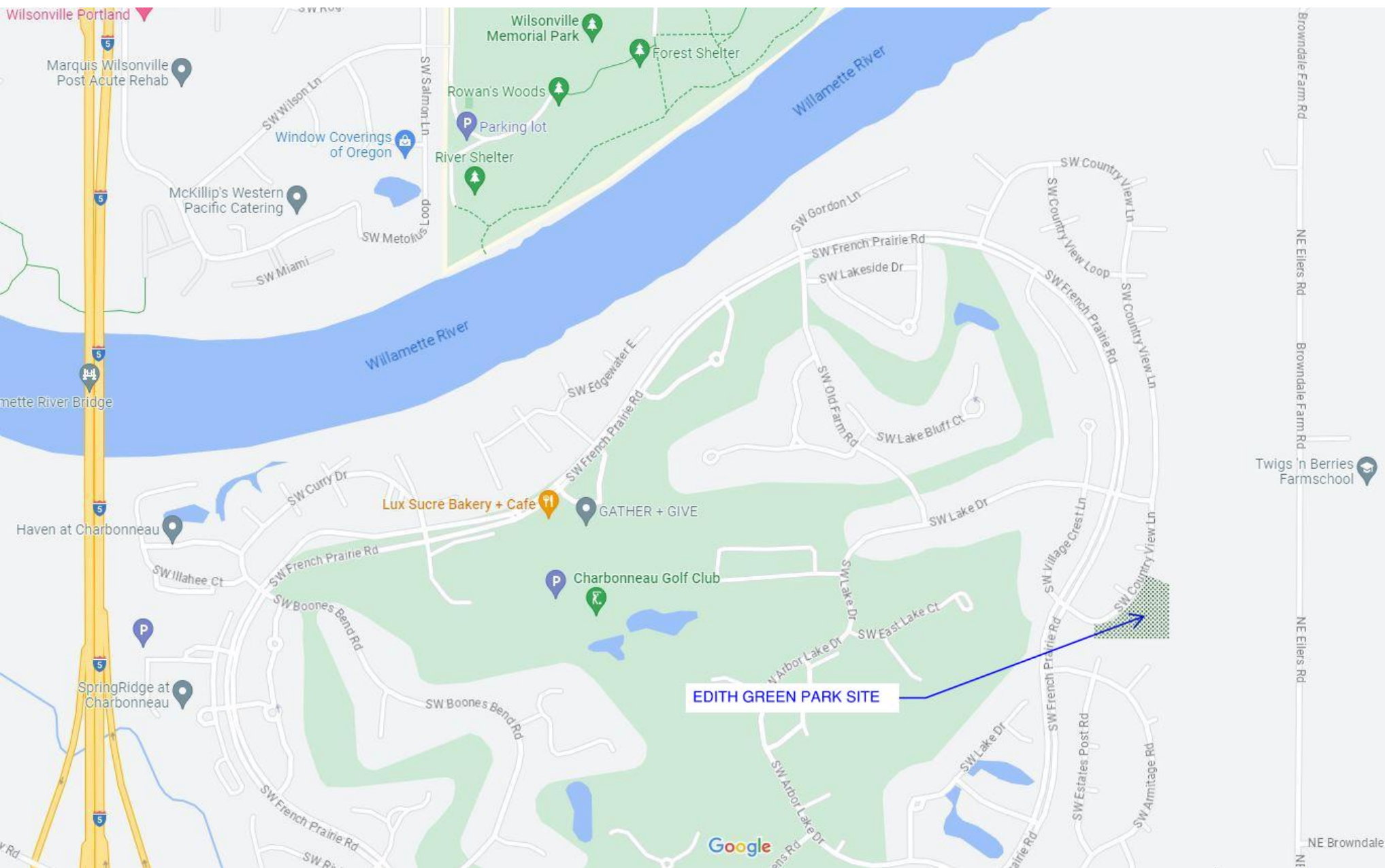

EDITH GREEN PARK – WILSONVILLE DESIGN REVIEW BOARD PANEL A – 14 AUGUST, 2023



# SITE AERIAL



EDITH GREEN PARK – WILSONVILLE DESIGN REVIEW BOARD PANEL A – 14 AUGUST, 2023



# SITE PHOTOS



SW Country View Ln.



South Property Line



North View @ mid site



South View @ mid site



Basketball Court at East



North Property Line



# SITE PLAN

© 2023 Copyright reserved. See Design Agreement. For use on this project only. Unauthorised reproduction of any part of this material is prohibited.  
SERA Design and Architecture, Inc. 5020231 24.36 PM



- SITWORKS PLAN - GENERAL NOTES**
1. NO RESTROOMS ARE PROPOSED IN THIS PROJECT.
  2. NO LIGHTING IMPROVEMENTS ARE PROPOSED IN THIS PROJECT.
  3. NO UTILITY IMPROVEMENTS ARE PROPOSED IN THIS PROJECT.
  4. NO RIGHT-OF-WAY IMPROVEMENTS ARE PROPOSED IN THIS PROJECT.
  5. NO TREES ARE PROPOSED IN THIS PROJECT.
  6. NO IMPROVEMENTS ARE PROPOSED WITHIN THE ROOT ZONE OF EXISTING STREET TREES.
  7. EXISTING IRRIGATION TO REMAIN IN PLACE AND BE ADJUSTED TO ACCOMMODATE SITE IMPROVEMENTS.

- LEGEND - SITE PLAN**
- | SYMBOL   | DESCRIPTION             | NOTES   |
|----------|-------------------------|---|
| [Symbol] | CONCRETE WALKWAY        | NATURAL GREY/BROOM FINISH   |
| [Symbol] | EXISTING LAWN           | REPAIR AND RE-SEED DISTURBED EXISTING LAWN  |
| [Symbol] | BOCCE COURT             | PERVIOUS SYNTHETIC TURF SURFACE WITH WOOD CURBS   |
| [Symbol] | EXISTING STREET TREES   | PROVIDE TREE PROTECTION PER CITY OF WILSONVILLE CODE  |
| [Symbol] | EXISTING HEDGES         | 15' HEIGHT, PROTECT IN PLACE  |
| [Symbol] | BENCHES                 | COLUMBA CASCADE - GREENWAY SERIES   |
| [Symbol] | PONIC TABLES            | COLUMBA CASCADE - PARKWAY SERIES  |
| [Symbol] | SHELTERS                | AMERICAN LANDSCAPE STRUCTURES (ALONG WITH SHEATING & CHARCOAL ROOF SHINGLES - RECTANGULAR ONE PER PLANT) UNIVERSAL DESIGN ELEMENT |
| [Symbol] | ACCESS POST             |   |
| [Symbol] | SCOREBOARD POST         |   |
| [Symbol] | BASKETBALL BACKSTOP     | ADJUSTABLE IN GROUND  |
| [Symbol] | DOG PARK FENCING        | 42" HEIGHT WOOD FENCING WITH POWDER COATED W/SH-ROCKET  |
| [Symbol] | GRAVEL FILTER STRIP     |   |
| [Symbol] | EXISTING WATER EASEMENT |   |

**MATERIAL AREA CALCULATIONS**

EXISTING IMPERVIOUS SURFACE	3,612 SF
PROPOSED IMPERVIOUS SURFACE	4,420 SF
PERVIOUS SURFACE & PLANTING	83,765 SF
<b>SITE TOTAL AREA</b>	<b>91,797 SF</b>



CONTEXT MAP



1 BOCCE COURT - TURF SURFACE  
NTS

2 SITWORKS PLAN  
1" = 20'-0"



ARCHITECTURE  
URBAN DESIGN + PLANNING  
INTERIOR DESIGN

PORTLAND/OREGON  
SEASIDE/OREGON

**PRELIMINARY**  
NOT FOR CONSTRUCTION

**EDITH GREEN PARK**  
ENTER CLIENT HERE  
ENTER ADDRESS HERE

REVISIONS

CHECKED BY: DJ  
ISSUE DATE: 05/02/23  
PROJECT NO: 2101036

**SITWORK PLAN**  
**LS101**

**DESIGN REVIEW**

# SITE DETAILS

© 2023 Copyright protected. Site Design Agreement. For use on this project only. Unauthorized reproduction of any part of this material is prohibited.  
 3/27/2023 1:24:36 PM  
 SERA Design and Architecture, Inc.



**9 BASKETBALL HOOP - ADJUSTABLE IN GROUND**  
NTS

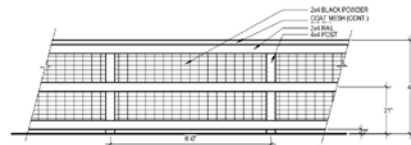

**5 DOG PARK FENCE - ELEVATION**  
1/2" = 1'-0"

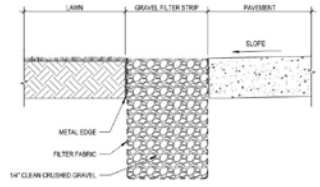

**1 GRAVEL FILTER STRIP**  
3/4" = 1'-0"



**10 BENCH - COLUMBIA CASCADE GREENWAY SERIES**  
NTS

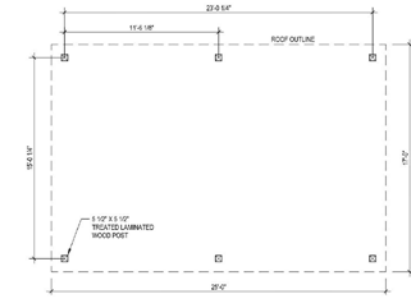

**6 SHELTER B - LAYOUT PLAN**  
1/4" = 1'-0"

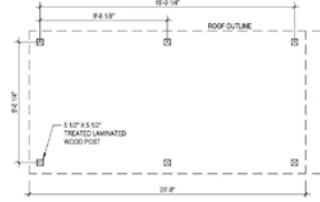

**2 SHELTER A - LAYOUT PLAN**  
1/4" = 1'-0"



**11 PICNIC TABLE - COLUMBIA CASCADE PARKWAY SERIES**  
NTS

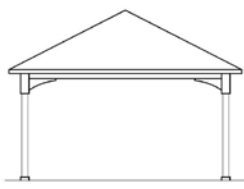

**7 SHELTER B - FRONT ELEVATION**  
1/4" = 1'-0"

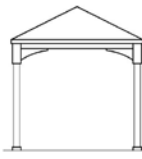

**3 SHELTER A - FRONT ELEVATION**  
1/4" = 1'-0"



**12 SHELTER - AMERICAN LANDSCAPE STRUCTURES**  
NTS

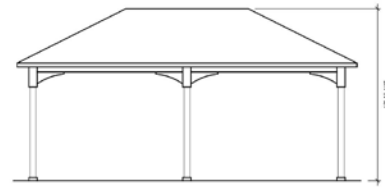

**8 SHELTER B - SIDE ELEVATION**  
1/4" = 1'-0"

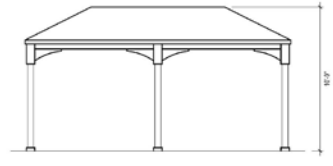

**4 SHELTER A - SIDE ELEVATION**  
1/4" = 1'-0"

**SERA**

ARCHITECTURE  
URBAN DESIGN + PLANNING  
INTERIOR DESIGN

PORTLAND/SPRINGFIELD  
SERVINGTHELOCAL

**PRELIMINARY**  
NOT FOR CONSTRUCTION

**EDITH GREEN PARK**  
ENTER CLIENT NAME  
ENTER ADDRESS HERE

REVISIONS

CHECKED BY: DJ  
DATE: 06/02/23  
PROJECT NO: 2-01106

**SITWORK  
DETAILS  
LS201**

**DESIGN REVIEW**